

CT·A

Tite-Lock Milling Chuck

- Slim design milling chuck. Clicking sound tells completion of clamping.

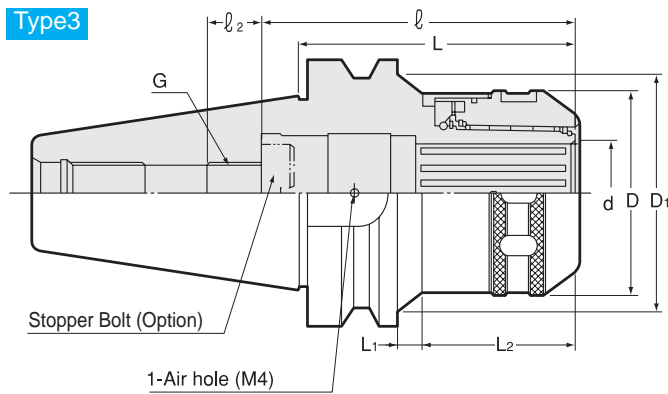
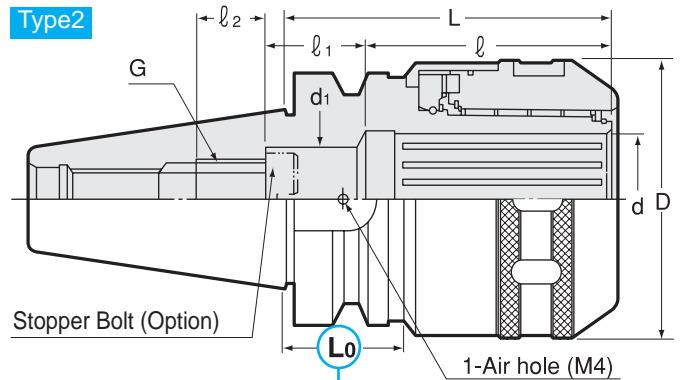
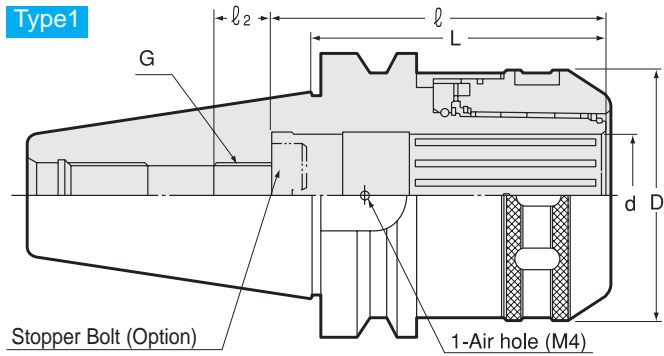

Caution
★ Take caution against A.T.C. arm and tool magazine interference.

Caution
Please rotate the clamping ring counterclockwise more than 360 degrees after a cutting tool is removed.

Metric Sizes

Unit : Metric

Code	Model	Type	d	D	D1	L	ℓ	ℓ_1	d1	L0	$P = \frac{G}{1.0}$	ℓ_2	L1	L2	kg	Spanner
0710 00116075	BT30 -CT16A -75	1	16	45	—	75	65	—	—	—	10	15	—	—	0.9	HS-1-16
0710 00116090	-90	1	16	45	—	90	65	—	—	—	10	15	—	—	1.1	
0710 00120090	BT30 -CT20A -90	2	20	52	—	90	80	—	—	★ 32	12	15	—	—	1.1	HS-2-20
0710 00120105	-105	2	20	52	—	105	80	—	—	★ 47	12	15	—	—	1.3	
0710 00125090	BT30 -CT25A -90	2	25	61	—	90	80	—	—	★ 32	12	15	—	—	1.3	HS-2.5-25
0710 00125105	-105	2	25	61	—	105	80	—	—	★ 37	12	15	—	—	1.6	
0710 00316075	BT40 -CT16A -75	3	16	45	48	75	65	—	—	—	10	15	2	46	1.4	HS-1-16
0710 00320090	BT40 -CT20A -90	3	20	52	55	90	80	—	—	—	12	15	6	57	1.7	
0710 00320105	-105	3	20	52	55	105	80	—	—	—	12	15	21	57	1.9	HS-2-20
0710 00320120	-120	3	20	52	58	120	80	—	—	—	12	15	36	57	2.2	
0710 00325090	BT40 -CT25A -90	1	25	61	—	90	80	—	—	—	12	15	—	—	1.9	HS-2.5-25
0710 00325105	-105	1	25	61	—	105	80	—	—	—	12	15	—	—	2.2	
0710 00325135	-135	1	25	61	—	135	80	—	—	—	12	15	—	—	2.9	
0710 00332090	BT40 -CT32A -90 * 1	2	32	73	—	90	76	32	26	★ 27	18	17	—	—	2.2	HS-3-32
0710 00332105	-105 * 2	2	32	73	—	105	85	23	26	42	18	17	—	—	2.5	
0710 00332120	-120 * 2	2	32	73	—	120	85	23	26	57	18	17	—	—	2.9	
0710 00332135	-135	2	32	73	—	135	120	—	—	72	18	17	—	—	3.1	
0710 00516090	BT50 -CT16A -90	3	16	45	56	90	65	—	—	—	10	20	6	46	4.0	HS-1-16
0710 00516105	-105	3	16	45	69	105	65	—	—	—	10	20	21	46	4.3	
0710 00520105	BT50 -CT20A -105	3	20	52	71	105	80	—	—	—	12	15	10	57	4.4	HS-2-20
0710 00520135	-135	3	20	52	73	135	80	—	—	—	12	15	40	57	5.0	
0710 00525105	BT50 -CT25A -105	3	25	61	79	105	80	—	—	—	12	15	9	58	4.7	HS-2.5-25
0710 00525135	-135	3	25	61	85	135	80	—	—	—	12	15	39	58	5.6	
0710 00525165	-165	3	25	61	83	165	80	—	—	—	12	15	69	58	6.4	

Metric Sizes Unit : Metric

Code	Model	Type	d	D	D1	L	ℓ	ℓ1	d1	L0	$P = \frac{G}{1.0}$	ℓ2	L1	L2	kg	Spanner
0710 00532105	BT50 -CT32A -105	3	32	73	75	105	120	—	—	—	18	20	2	65	4.8	HS-3-32
0710 00532120	-120	3	32	73	85	120	120	—	—	—	18	20	17	65	5.4	
0710 00532135	-135	3	32	73	84	135	120	—	—	—	18	20	32	65	5.9	
0710 00532150	-150	3	32	73	89	150	120	—	—	—	18	20	47	65	6.5	
0710 00532165	-165	3	32	73	88	165	120	—	—	—	18	20	62	65	7.0	
0710 00542105	BT50 -CT42A -105 * 3	1	42	88	—	105	120	—	—	—	18	20	—	—	5.2	HS-4-42
0710 00542120	-120	1	42	88	—	120	120	—	—	—	18	20	—	—	5.8	
0710 00542135	-135	1	42	88	—	135	120	—	—	—	18	20	—	—	6.5	
0710 00542150	-150	1	42	88	—	150	120	—	—	—	18	20	—	—	7.1	
0710 00542165	-165	1	42	88	—	165	120	—	—	—	18	20	—	—	7.8	

1. Use 1 pcs. of M4 x 5 (S) hex. screw (included) to close air hole on the holder when internal coolant is used.
2. When ordering, indicate number of spanners required. "No charge" spanners are limited to number of milling chucks on order.
3. Tolerance of cutting tool shank must be h7.

Ordering Example

BT30 - CT 16 A - 75
 Shank size I.D. (d) Projection length (L)

Spanner

P. 069



Accessories

Models with * 1 - * 3 cannot be used with some accessories due to short ℓ length.

	Stopper Bolt	Straight Collet		Morse Taper Adapter		Jacobs Adapter	
	BL (P.068)	MC (P.066)	MCA (P.067)	MA (P.068)	MAB (P.068)	JA (P.069)	JAB (P.069)
* 1	Yes	Yes	No	No	Yes	No	Yes
* 2	Yes	Yes	Yes	No	Yes	No	Yes
* 3	Yes	Yes	No	Yes	Yes	Yes	Yes

Min. chucking length

Without MC collet

I.D. of Milling Chuck	Min. chucking length
16	40
20, 25	45
32, 42	60

With MC collet

Collet I.D.	Min. chucking length
6, 8	30
10, 12	40
16, 20	45
25	55
32	60

CT·A

Tite-Lock Milling Chuck

- Slim design milling chuck. Clicking sound tells completion of clamping.

Type1

Coolant tube

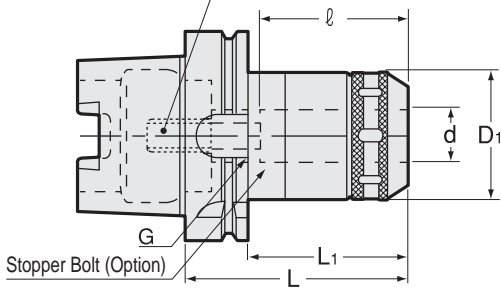

Type2

Coolant tube

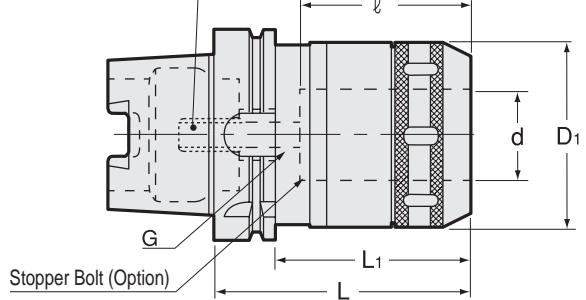

Type3

Coolant tube

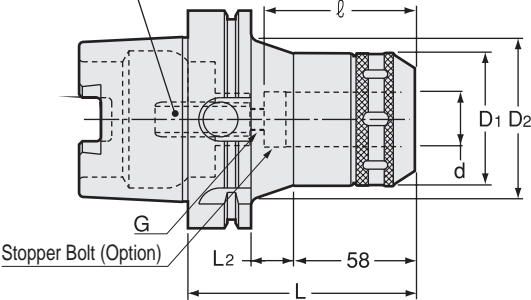

Caution

Please rotate the clamping ring counterclockwise more than 360 degrees after a cutting tool is removed.

- Coolant tube is included.





Metric Sizes Unit : Metric

Code	Model	Type	d	L	L1	L2	D1	D2	G	ℓ	kg	Spanner
5320 13016090	HSK40A -CT16A -90 * 1	2	16	90	70	-	45	-	M5	60	0.8	HS-1-16
5320 13020105	HSK40A -CT20A -105 * 2	2	20	105	85	-	52	-	M5	60	1.2	HS-2-20
5320 13025105	HSK40A -CT25A -105 * 2	2	25	105	85	-	61	-	M5	60	1.5	HS-2.5-25
5320 14016090	HSK50A -CT16A -90 * 1	2	16	90	64	-	45	-	M5	60	1.0	HS-1-16
5320 14020105	HSK50A -CT20A -105 * 2	2	20	105	79	-	52	-	M5	60	1.4	HS-2-20
5320 14025105	HSK50A -CT25A -105 * 2	2	25	105	79	-	61	-	M5	60	1.6	HS-2.5-25
5320 15020105	HSK63A -CT20A -105 * 1	1	20	105	79	-	52	-	M8	75	1.7	HS-2-20
5320 15020135	-135 * 1	1	20	135	109	-	52	-	M8	80	2.1	HS-2-20
5320 15025105	HSK63A -CT25A -105 * 1	2	25	105	79	-	61	-	M8	75	1.9	HS-2.5-25
5320 15025135	-135 * 1	2	25	135	109	-	61	-	M8	80	2.4	HS-2.5-25
5320 15032120	HSK63A -CT32A -120 * 3	2	32	120	94	-	73	-	M8	90	2.5	HS-3-32
5320 15032150	-150 * 1	2	32	150	124	-	73	-	M8	120	3.1	HS-3-32
5320 17020105	HSK100A -CT20A -105 * 4	3	20	105	76	18	52	73	M10	70	3.2	HS-2-20
5320 17020135	-135	3	20	135	106	48	52	78	M10	80	3.9	HS-2-20
5320 17020150	-150	3	20	150	121	63	52	74	M10	80	4.2	HS-2-20
5320 17025105	HSK100A -CT25A -105 * 5	3	25	105	76	18	61	71	M10	70	3.6	HS-2.5-25
5320 17025135	-135	3	25	135	106	48	61	73	M10	80	4.2	HS-2.5-25
5320 17025150	-150	3	25	150	121	63	61	73	M10	80	4.6	HS-2.5-25
5320 17032105	HSK100A -CT32A -105 * 2	1	32	105	76	-	73	-	M10	70	3.9	HS-3-32
5320 17032135	-135 * 1	1	32	135	106	-	73	-	M10	100	4.6	HS-3-32
5320 17032150	-150 * 1	1	32	150	121	-	73	-	M10	115	5.0	HS-3-32
5320 17042135	HSK100A -CT42A -135 * 2	2	42	135	106	-	88	-	M10	100	5.6	HS-4-42
5320 17042150	-150 * 2	2	42	150	121	-	88	-	M10	110	6.5	HS-4-42
5320 17042165	-165 * 1	2	42	165	136	-	88	-	M10	120	7.0	HS-4-42

1. When ordering, indicate number of spanners required. "No charge" spanners are limited to number of milling chucks on order.
2. Tolerance of cutting tool shank must be h7.

Accessories

Models with * 1 - * 5 cannot be used with some accessories due to short l length.

	Stopper Bolt 	Straight Collet 		Morse Taper Adapter 		Jacobs Adapter 	
	BL (P.295)	MC (P.066)	MCA (P.067)	MA (P.068)	MAB (P.068)	JA (P.069)	JAB (P.069)
* 1	Yes	Yes	No	Yes	Yes	Yes	Yes
* 2	Yes	Yes	No	No	No	No	No
* 3	Yes	Yes	No	No	Yes	No	Yes
* 4	Yes	Yes	Yes	Yes	No	Yes	No
* 5	Yes	Yes	Yes	No	No	Yes	No

Min. chucking length

Without MC collet

I.D.of Milling Chuck	Min. chucking length
16	40
20, 25	45
32, 42	60

With MC collet

Collet I.D.	Min. chucking length
6, 8	30
10, 12	40
16, 20	45
25	55
32	60

Spanner

P. 069



Ordering Example

HSK40A - CT 16 A - 90
 Shank size I.D. (d) Projection length (L)

Stopper Bolt (for HSK)

HSK-BL

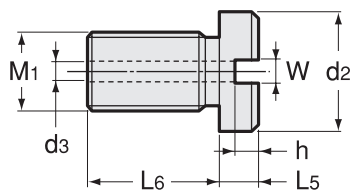

Code	Model	M1	L5	L6	W	h	d2	d3	Shank size
5691 040040 ※※	HSK40 -BL -L5	M5 P=0.8	5、 15、 25	8.5	5	2.5	13	2.5	HSK40A, HSK50A
5691 04006305	HSK63 -BL -5	M8 P=1.25	5	5.5	5	3	15	4	HSK63A
5691 040063 ※※	HSK63 -BL -L5	M8 P=1.25	15、 25	7.5	5	3	15	4	HSK63A
5691 040100 ※※	HSK100 -BL -L5	M10 P=1.5	5、 15、 25	14	5	3.5	15	4.5	HSK100A

Choose right L5 dimension by checking minimum insertion length and shank I.D. depth.

Ordering Example

HSK63 - BL - 15
 Shank Size L5

CT·A

Tite-Lock Milling Chuck

- Slim design milling chuck. Clicking sound tells completion of clamping.

Type1

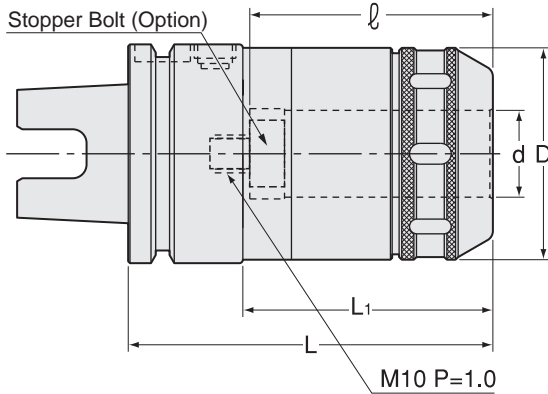

Type2

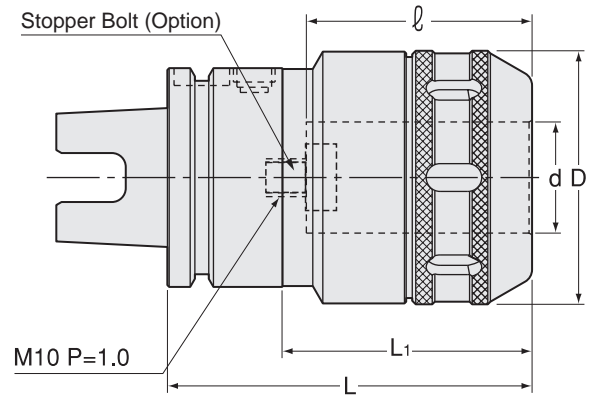

Caution

Please rotate the clamping ring counterclockwise more than 360 degrees after a cutting tool is removed.

Metric Sizes

Unit : Metric





Code	Model	Type	d	D	L	L1	ℓ	kg	Spanner
1280 01116090	UTS5040 -CT16A 90-H * 1	1	16	45	90	60	60	1.1	HS-1-16
1280 01120105	UTS5040 -CT20A 105-H * 1	2	20	52	105	75	75		HS-2-20
1280 01125105	UTS5040 -CT25A 105-H * 1	2	25	61	105	75	75	1.7	HS-2.5-25
1280 0 ※ 216090	UTS6350 -CT16A -90	1	16	45	90	57	65		HS-1-16
1280 0 ※ 220105	UTS6350 -CT20A -105	1	20	52	105	72	75	1.7	HS-2-20
1280 0 ※ 220135	-135	1	20	52	135	102	80		HS-2-20
1280 0 ※ 225105	UTS6350 -CT25A -105	1	25	61	105	72	75	2.1	HS-2.5-25
1280 0 ※ 225135	-135	1	25	61	135	102	80		HS-2.5-25
1280 0 ※ 232120	UTS6350 -CT32A -120 * 2	2	32	73	120	87	90	2.7	HS-3-32
1280 0 ※ 232150	-150 * 1	2	32	73	150	117	120		HS-3-32
1280 0 ※ 316090	UTS10080 -CT16A -90	1	16	45	90	56	65		HS-1-16
1280 0 ※ 316105	-105	1	16	45	105	71	65		HS-1-16
1280 0 ※ 320105	UTS10080 -CT20A -105 * 3	1	20	52	105	71	70		HS-2-20
1280 0 ※ 320135	-135	1	20	52	135	101	80		HS-2-20
1280 0 ※ 320150	-150	1	20	52	150	116	80		HS-2-20
1280 0 ※ 325105	UTS10080 -CT25A -105 * 4	1	25	61	105	71	70		HS-2.5-25
1280 0 ※ 325135	-135	1	25	61	135	101	80		HS-2.5-25
1280 0 ※ 325150	-150	1	25	61	150	116	80		HS-2.5-25
1280 0 ※ 332105	UTS10080 -CT32A -105 * 5	1	32	73	105	71	70		HS-3-32
1280 0 ※ 332135	-135 * 1	1	32	73	135	101	100	3.9	HS-3-32
1280 0 ※ 332150	-150 * 1	1	32	73	150	116	115		HS-3-32
1280 0 ※ 342135	UTS10080 -CT42A -135 * 5	1	42	88	135	101	100		HS-4-42
1280 0 ※ 342150	-150 * 5	1	42	88	150	116	110		HS-4-42
1280 0 ※ 342165	-165 * 1	1	42	88	165	131	120		HS-4-42

When placing an order, please specify high or low pressure. For high pressure type, please add (-H) on end of the description.

1. When ordering, indicate number of spanners required. "No charge" spanners are limited to number of milling chucks on order.
2. Tolerance of cutting tool shank must be h7.
3. UTS5040 is available in high pressure only.

Accessories

Models with * 1 - * 5 cannot be used with some accessories due to short ℓ length.

	Stopper Bolt 	Straight Collet 		Morse Taper Adapter 		Jacobs Adapter 	
	BL (P.389)	MC (P.066)	MCA (P.067)	MA (P.068)	MAB (P.068)	JA (P.069)	JAB (P.069)
* 1	BL16 only	Yes	No	Yes	Yes	Yes	Yes
* 2	BL16 only	Yes	No	No	Yes	No	Yes
* 3	BL16 only	Yes	Yes	Yes	No	Yes	No
* 4	BL16 only	Yes	Yes	No	No	Yes	No
* 5	BL16 only	Yes	No	No	No	No	No

Min. chucking length

Without MC collet

I.D. of Milling Chuck	Min. chucking length
16	40
20, 25	45
32, 42	60

With MC collet

Collet I.D.	Min. chucking length
6, 8	30
10, 12	40
16, 20	45
25	55
32	60

Spanner

P. 069



Ordering Example

Low pressure type

0 ~ 1.0MPa (UTS10080 : 0 ~ 2.0MPa)

UTS6350 - CT 32 A - 120
 Shank size I.D. (d) Projection length (L)

Ordering Example

High pressure type

1.1 ~ 7.0MPa (UTS10080 : 2.1 ~ 7.0MPa)

UTS6350 - CT 32 A - 120 - H
 Shank size I.D. (d) Projection length (L) High pressure type

Stopper Bolt (for UTS)

BL

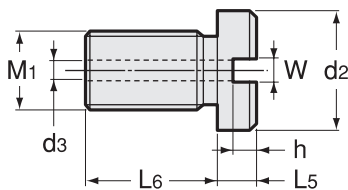

Code	Model	M1 P=1.0	L5	L6	W	h	d2	d3	Chucks
0711 040016 ※※	BL 16 -L5	10	5, 15, 25	14	5	3.5	15	4.5	CT16 ~ 42

Choose right L5 dimension by checking minimum insertion length and shank I.D. depth.

Ordering Example

BL16 - 15
 Size L5