



For CNC lathe · internal coolant

# Coolant Bit Sleeves ST·U-CBS<sup>PAT.P</sup>



## All Coolant Is Supplied To The Cutting Edge Without Loss!

Eliminates coolant leakage problems with conventional tool sleeves and achieves more efficient machining.



See ST·U-CBS in action!



## No coolant leaks from the shank flats!

### Seal stopper (PAT.P)

Pushed by coolant pressure and adheres to the tool shank end face to prevent coolant leakage from the tool shank flat!

- No decrease in coolant pressure at cutting edge
- Improved surface finish accuracy
- Improved chip removal

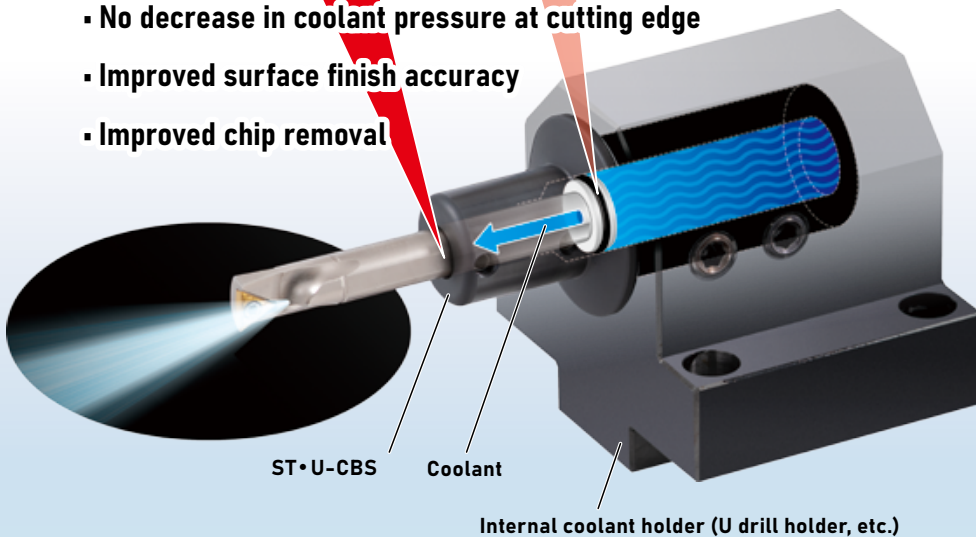

**Please contact our sales department if you would like to try out this product!**

# Coolant Bit Sleeve ST·U-CBS

Type1

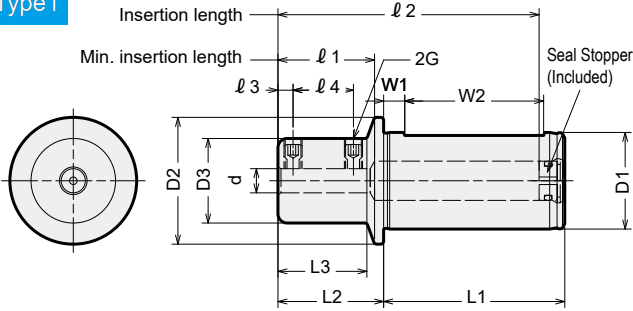

Type2

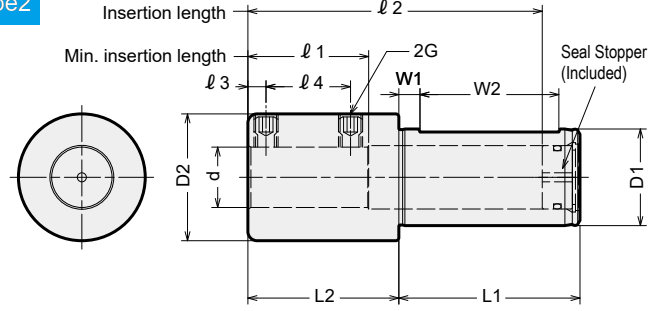

Code	Model	Type	d	D1	D2	D3	L1	L2	L3	l1	l2	l3	l4	W1	W2	G
0490 02508000	ST25U - CBS08	1	8	25	34	28	56	35	30.9	32	82	5	20	7	42	M6
0490 02510000	- CBS10	1	10	25	34	28	56	35	30.9	32	82	5	20	7	42	M6
0490 02512000	- CBS12	1	12	25	34	28	56	35	30.9	36	82	5	20	7	42	M6
0490 02516000	- CBS16	2	16	25	34	—	56	45	—	35	92	5	25	7	42	M6
0490 03208000	ST32U - CBS08	1	8	32	42	28	60	35	29.5	32	86	5	20	7	46	M6
0490 03210000	- CBS10	1	10	32	42	28	60	35	29.5	32	86	5	20	7	46	M6
0490 03212000	- CBS12	1	12	32	42	28	60	35	29.5	36	86	5	20	7	46	M6
0490 03216000	- CBS16	1	16	32	42	34	60	45	40.5	40	96	5	28	7	46	M6
0490 03220000	- CBS20	2	20	32	42	—	60	50	—	40	97	6	28	7	46	M8
0490 04008000	ST40U - CBS08	1	8	40	50	28	70	40	33	38	101	5	20	7	56	M6
0490 04010000	- CBS10	1	10	40	50	28	70	40	33	38	101	5	23	7	56	M6
0490 04012000	- CBS12	1	12	40	50	28	70	40	33	38	101	5	23	7	56	M6
0490 04016000	- CBS16	1	16	40	50	34	70	45	39.1	40	106	5	28	7	56	M6
0490 04020000	- CBS20	1	20	40	50	42	70	50	45.5	45	107	6	33	7	56	M8
0490 04025000	- CBS25	2	25	40	50	—	70	55	—	45	112	6	33	7	56	M8

- Supported holders : Internal coolant holder of CNC lathe (U drill holder, etc.)
- Supported tool : Boring bar only
- Cutters must be inserted at least the minimum insertion length. If the minimum insertion length is not met, the seal stopper will not function and coolant will leak.

### Order Example

**ST25U - CBS08**  
Shank size I.D.

## Polygon Taper Shank Tooling Series

Shank size : C3 ~ C6 ISO 26623-1 / JIS B 6066-1

### High repeat-mounting accuracy.

The polygon coupling ensures excellent accuracy in rotational direction.

#### Product details



# NT TOOL CORPORATION

2023.07.

TECHNO MAIL [technomail@nttool.co.jp](mailto:technomail@nttool.co.jp) For technical question, please contact us by technomail.

NT TOOL CORPORATION (HEAD OFFICE) : [en.nttool.com](http://en.nttool.com)  
NT USA CORPORATION (OFFICE) : [www.nttoolusa.com](http://www.nttoolusa.com)

NT TOOL EUROPE GmbH (OFFICE) : [www.nttooleurope.com](http://www.nttooleurope.com)  
NT TOOL THAI CO., LTD. (OFFICE) : [nttoothai.com](http://nttoothai.com)

NT TOOL DE MEXICO S.A. DE C.V. (OFFICE) : [www.nttool.com.mx](http://www.nttool.com.mx)